

Burner Nozzle

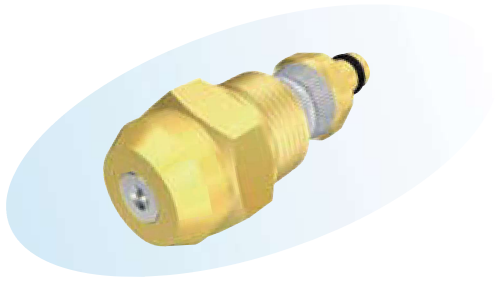

Features

- Spray flow rate can be adjustable within a wide range by controlling the return pressure.
- Uniform atomizing throughout the flow rate range.

Applications

- Water heater (oil-fired) burner.
- Humidification and air conditioning.
- Atomizing of chemical.

Materials

- Principal parts : Stainless steel
- Nozzle case : Brass
- O-ring : Nitrile elastomer

Shapes and dimensions

● BN

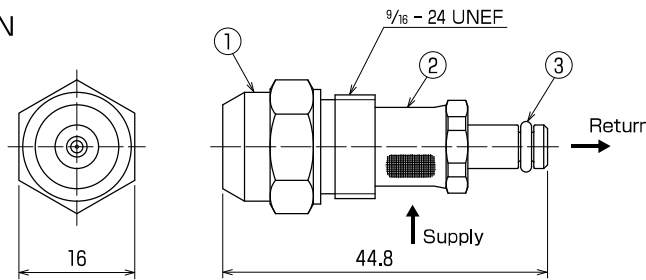

No.	Part name
1	Nozzle body
2	Filter
3	O-ring

Weight [g] 30

Performance data

Characteristic curves

Nozzle model number BN 3.0 - 60

Supply pressure: 0.7 MPa
Fluid: Kerosene (JIS No.1)

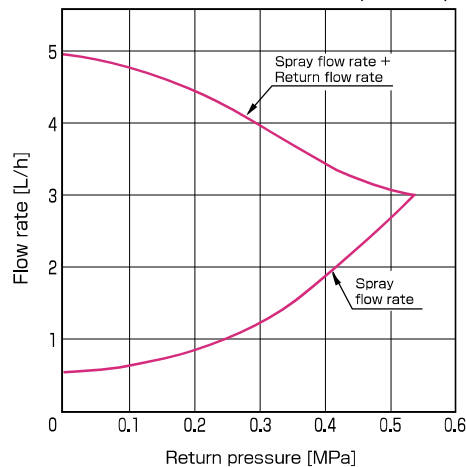

Model and Model Number representing

BN 3.0 - 60
|
Model number